



Learn how to print plastics stronger than Aluminium and hear from the experts about affordable Metal 3D printing!

When: 23rd May 2019

Time: 9.30 - 12.00 (tea and coffee available from 9.00am).

Where: Brunel University, The Hamilton Centre, Kingston Lane, Uxbridge, UB8 3PH



Learn about the ROI gained by Dunlop Systems and Components and see how it was calculated by the production engineering team. Listen to the real-life examples and then develop your own ROI.

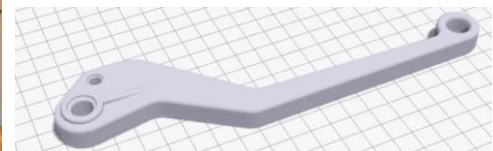

See how easy it is to use the Eiger software, which comes free with every machine. Bring your own components along as an .STL file and try them

Watch Us Print Composite Parts That Are ‘Stronger than Aluminium’

Learn how to:

- Cut manufacturing costs
- Reduce lead times
- Free up CNC machines
- Create new business opportunities
- Calculate an ROI on 3D printing.

Hear about Metal 3D Printing

Learn about the new affordable metal solution available from Markforged. Find out more about the new materials being released through 2019 and learn how to spot metal printing opportunities inside your business.

Bring your own .STL files

Find out how to create an account for yourself in Eiger, the complementary Markforged software that accompanies every machine. Load your own files in to the software and quickly create composite printed parts. Generate accurate part costs & run times to help with your ROI.

Meet the Team

Meet the team at Mark3D UK and chat to the experts from Markforged. Talk to them about your printing needs for the future and hear about what's new in the market place. Ask questions about the product range and learn tips and tricks.

*places are limited so please confirm your attendance asap to avoid disappointment

FIND OUT MORE

0800 193 3650

www.mark3d.co.uk

 mark3dUK

 @Mark3dUK

 mark3d-uk-limited



HOW TO FIND US

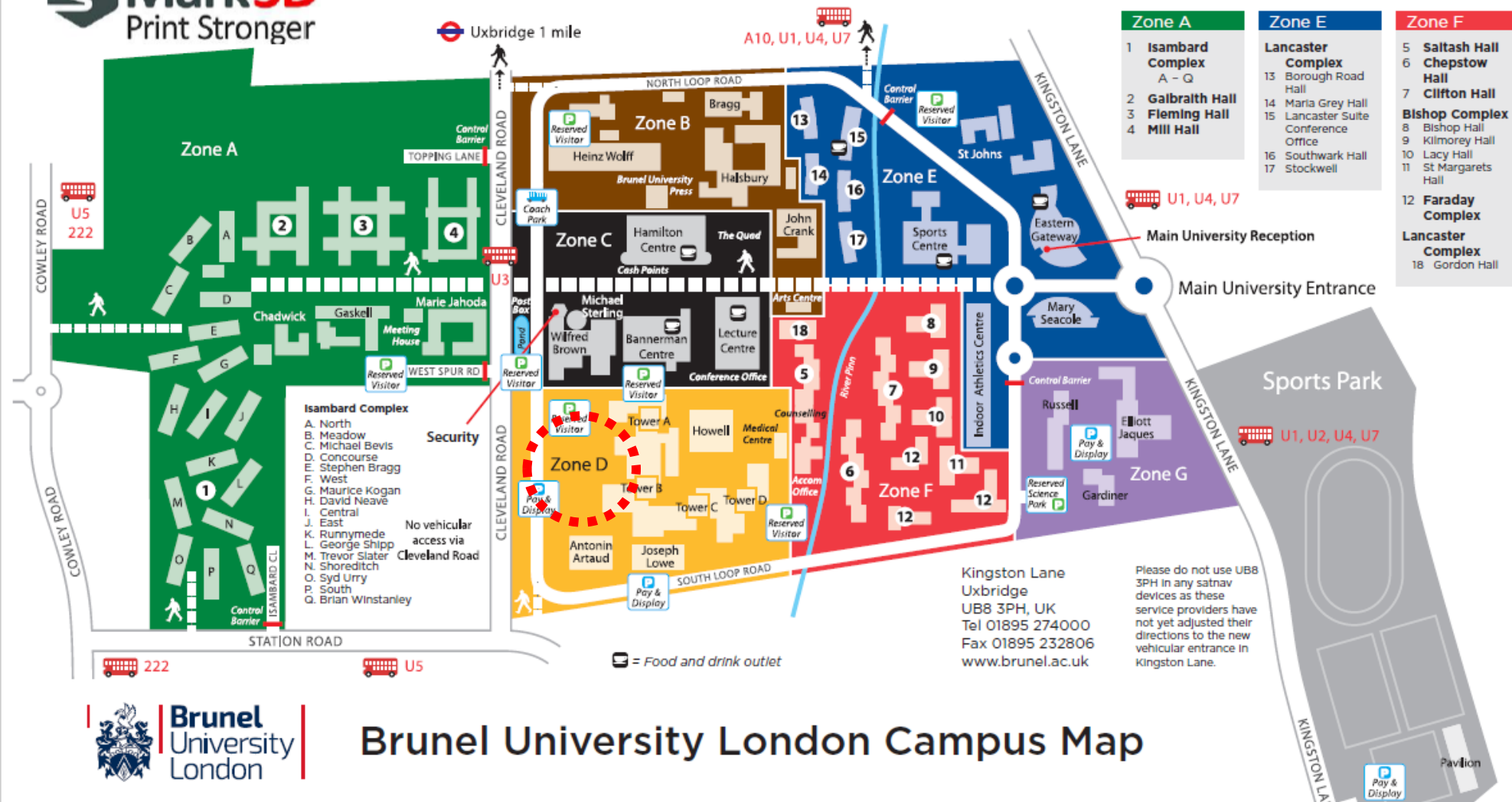

Brunel University London Campus Map

PARKING

Please park in Zone D and display the pass you have been provided.
The Hamilton Centre can be reached on foot by passing between the Wilfred Brown and Bannerman Centre.

HOW TO FIND US



Getting to Brunel University London

BY BUS

From Heathrow Central: A10 "Heathrow Fast", every 15 minutes, journey time approx 25 minutes (alight Hillingdon Rd at 'The Greenway' and use footpath to campus).

From Stockley Park: A10 "Heathrow Fast" as above, journey time approx 10 minutes.

From West Drayton railway station:

U3 (alight Cleveland Road)
U1 (alight Kingston Lane)
222 (alight Cowley Road and use path via Zone A, see campus map).

From Uxbridge (underground) station:

U3 (alight Cleveland Road)
U1 (to West Drayton) U4 and U7 (alight Kingston Lane)
222 and U5 (alight Cowley Road and use path via Zone A, see campus map).

BY UNDERGROUND

(Transport for London) For Uxbridge Station take the Metropolitan Line from central London (and Piccadilly Line during peak hours). Then take a taxi, or bus U1, U3, U4 or U7. (Alternatively use the 1-mile walking route shown on the right.)

BY RAIL

West Drayton (First Great Western Link) is the nearest main-line station (approx 1.5 miles from the campus). Services from London Paddington or the West (Bristol). From West Drayton station take a bus towards Uxbridge: 222 (alight Cowley Road), U5 (alight Station Road), U3 (alight Cleveland Road) or U1 (alight Kingston Lane).

West Ruislip Station (Chiltern Railways) is the main-line service from London Marylebone and the North (Aylesbury, Banbury and Birmingham) and is approximately 4 miles from the campus. From West Ruislip Station take the U1 bus towards West Drayton, alight Kingston Lane.



BY ROAD

Entry by car is via Kingston Lane only. Please do not use UBB 3PH in any satnav devices as these service providers have not yet adjusted their directions to the new vehicular entrance in Kingston Lane. Parking on the Uxbridge Campus and in the local area is very restricted. Barriers control access to the site and all vehicles must display a valid permit. On arrival, visitors may apply for a permit for the day from the main Reception Desk in the Eastern Gateway Building. In addition, pay-and-display parking is available on site.

Parking Charge Notices will be issued for illegally parked vehicles.

M4: Leave M4 at Junction 4 and follow signs to Uxbridge (A408). Straight across first set of traffic lights, continue on

A408, crossing four roundabouts. Turn right at the next set of major traffic lights. Continue ahead to next set of lights and, almost immediately, take the right filter lane at second set of traffic lights into Station Road. Continue straight on into Church Road and take the first exit at a mini-roundabout into Pield Heath Road. Turn left into Kingston Lane and left into the University. Follow signs for main Reception as you enter the campus.

A40/M40: At Swakeleys Roundabout take B483 exit to Uxbridge. Follow signs across two mini-roundabouts. At major roundabout bear left onto A4020 (Brunel sign), straight ahead at the first lights, then almost immediately take second right filter turn onto Kingston Lane (signposted Brunel). The main entrance to Brunel is right at the next roundabout.

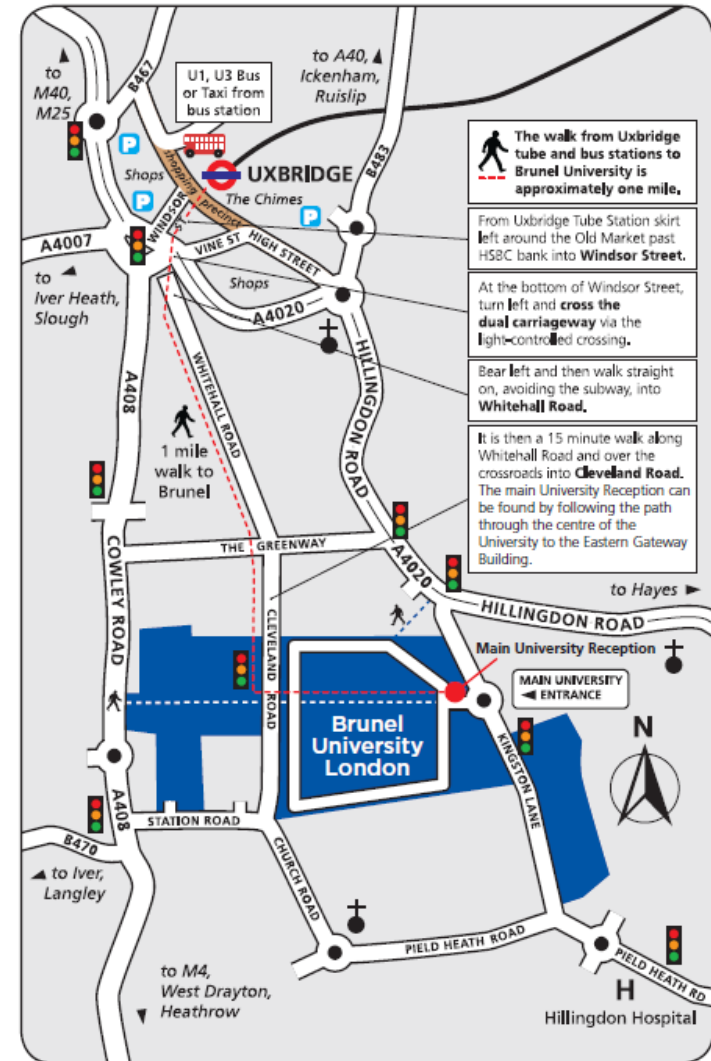

The walk from Uxbridge tube and bus stations to Brunel University is approximately one mile.

From Uxbridge Tube Station skirt left around the Old Market past HSBC bank into Windsor Street.

At the bottom of Windsor Street, turn left and cross the dual carriageway via the light-controlled crossing.

Bear left and then walk straight on, avoiding the subway, into Whitehall Road.

It is then a 15 minute walk along Whitehall Road and over the crossroads into Cleveland Road. The main University Reception can be found by following the path through the University to the Eastern Gateway Building.

Follow signs for Main Reception as you enter the campus.

M25: (From North or South) Join M40 or M4 then see above.

VISITOR PARKING FOR DISABLED BLUE BADGE HOLDERS

Accessible parking bays are available at various locations around the campus. Please collect a permit on arrival from Main Reception, Eastern Gateway Building.